

Cardboard Footswitch DIY MIDI Controller

.....
Step-by-step instructions

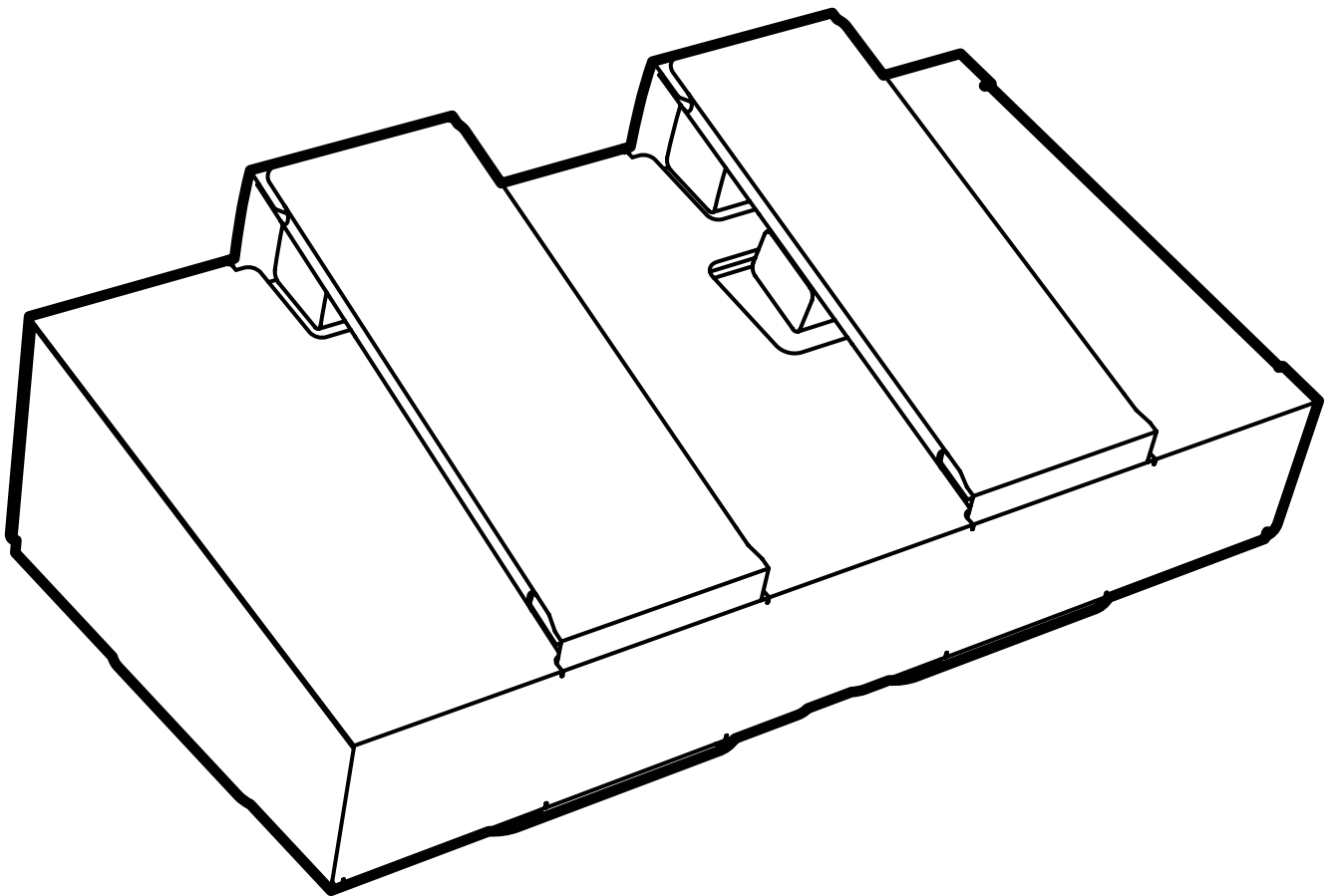

Important information

Read carefully.

Keep this information for further reference.

- Do not use the Cardboard Footswitch in bad weather conditions, when there is high humidity or other conditions in which a cardboard device can get damaged.
- Do not jump on the pedal and do not stand on it with your full body weight, due to its limited strength and the iPhone placed in it. Despite the protection, it may get damaged.
- Children should only use the Cardboard Footswitch under adult supervision to ensure the safety of the iPhone used.
- Be especially careful if you have assembled the model yourself from the downloaded template. Before the first use, check the strength of the pedal. The strength of the Cardboard Footswitch Certified Kit has been confirmed by tests. For a model made from the free template, a lot depends on you.
- We recommend using the iPhone without foil or glass protecting the screen.
- Such safeguards can cause instability in operation.

Assembly is easy and takes only a few minutes.

You don't need any geeky knowledge, no glue or tools to build the Cardboard Footswitch.

*The Cardboard Footswitch is fully compatible with the iOS **MIDI Footswitch** app.*



The set includes:

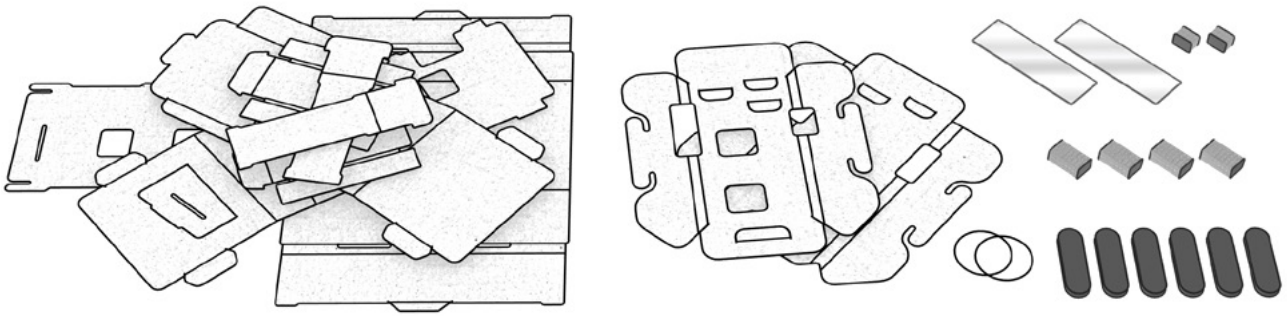

Meaning of symbols:



- important information / element requires action

Click! - interlocking parts “click” into position



- correct arrangement of elements



- incorrect arrangement of elements

1

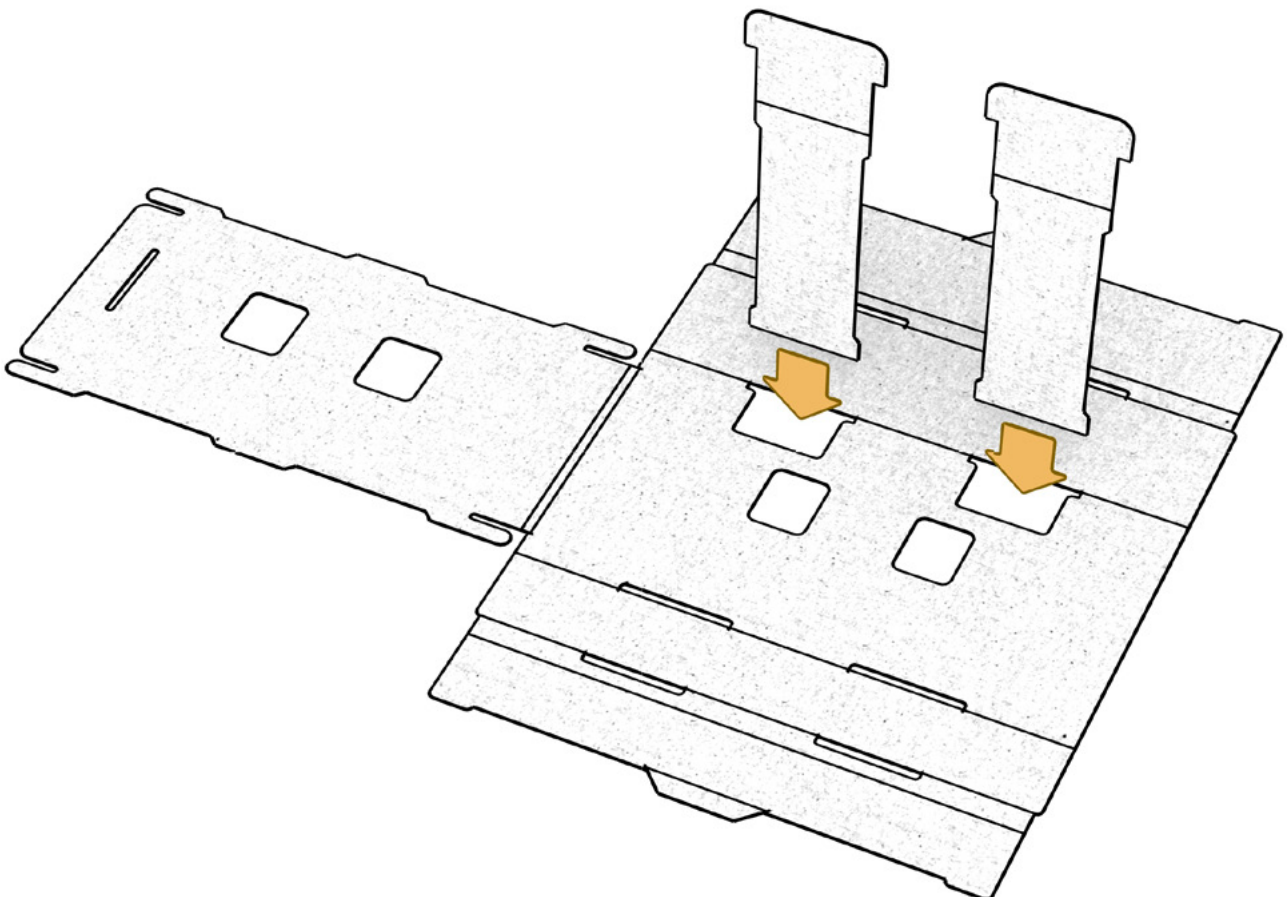

2

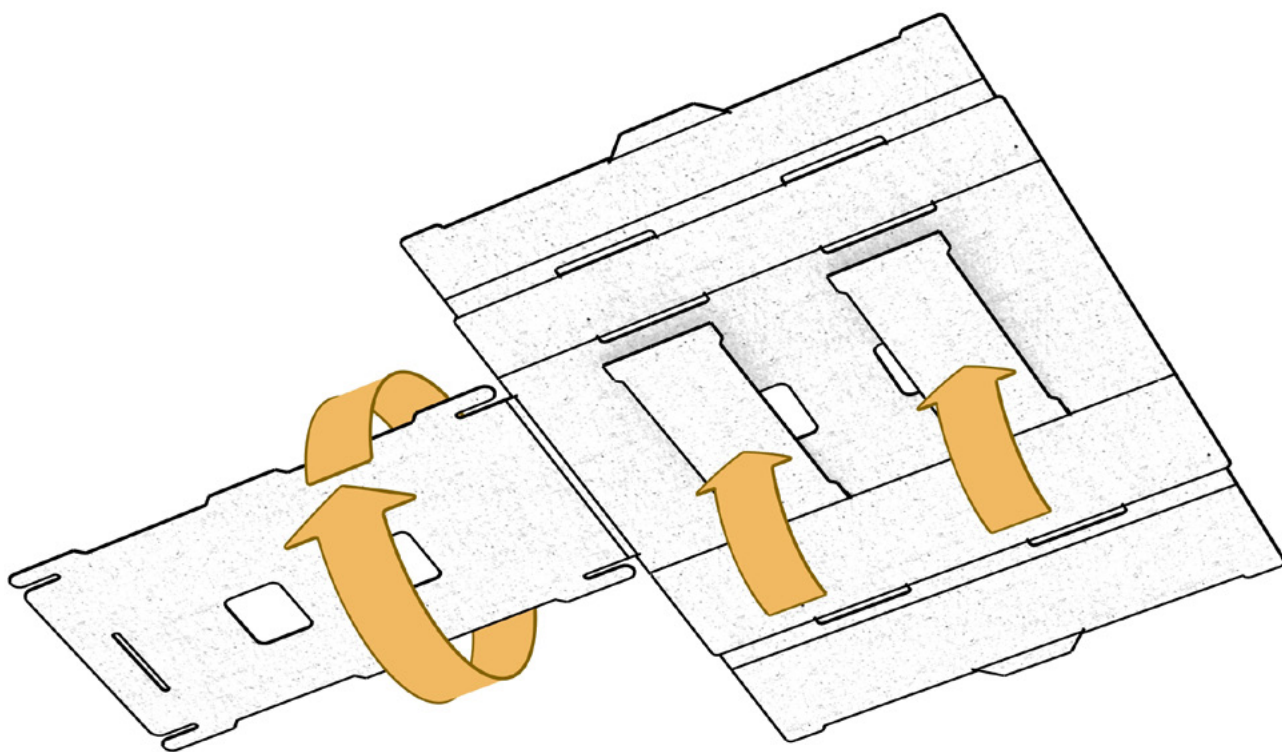

3

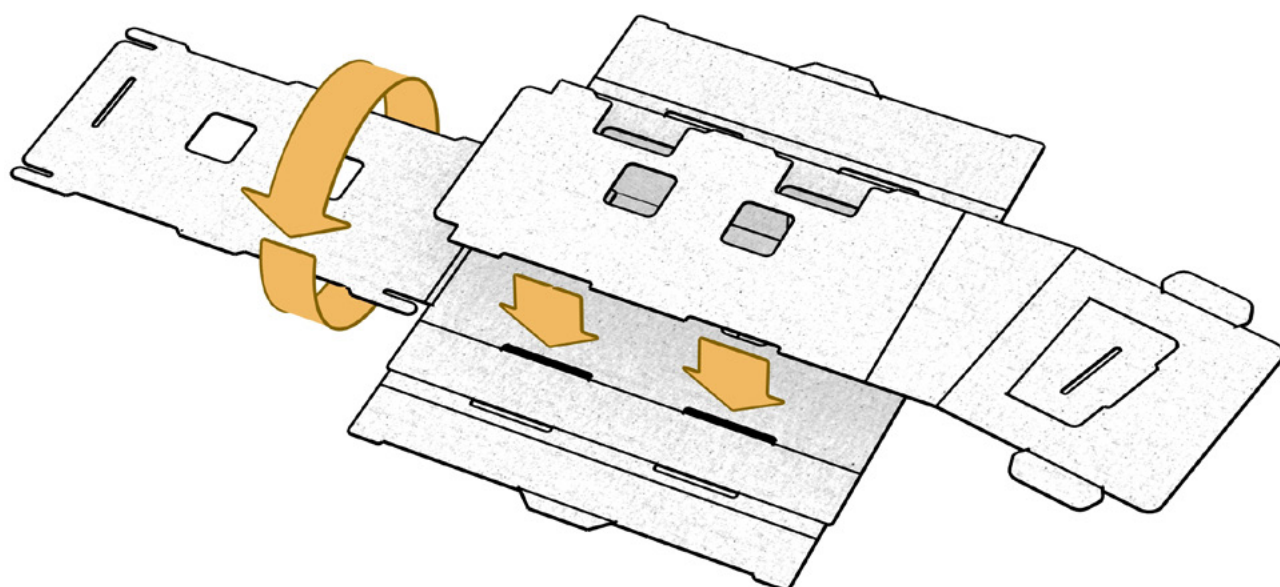

4

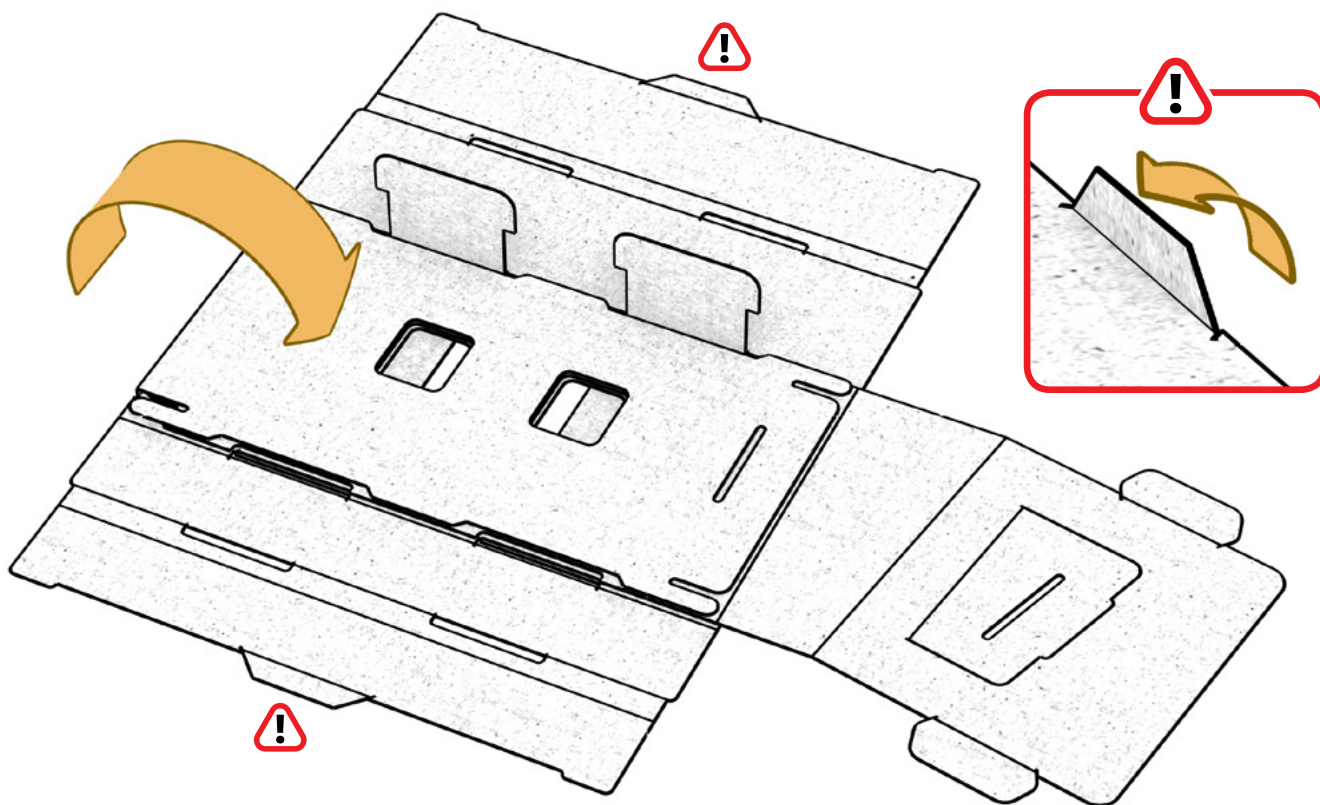

5

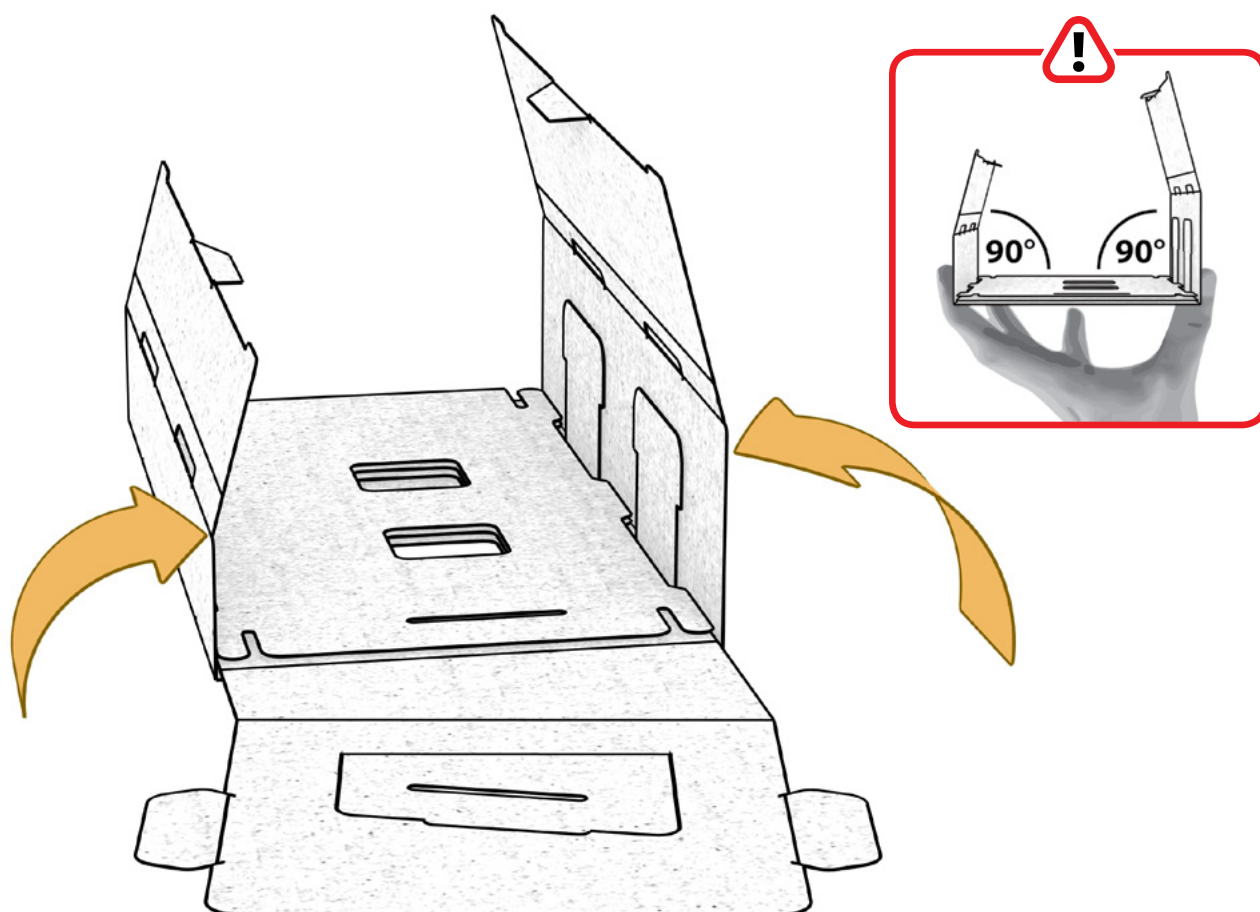

6

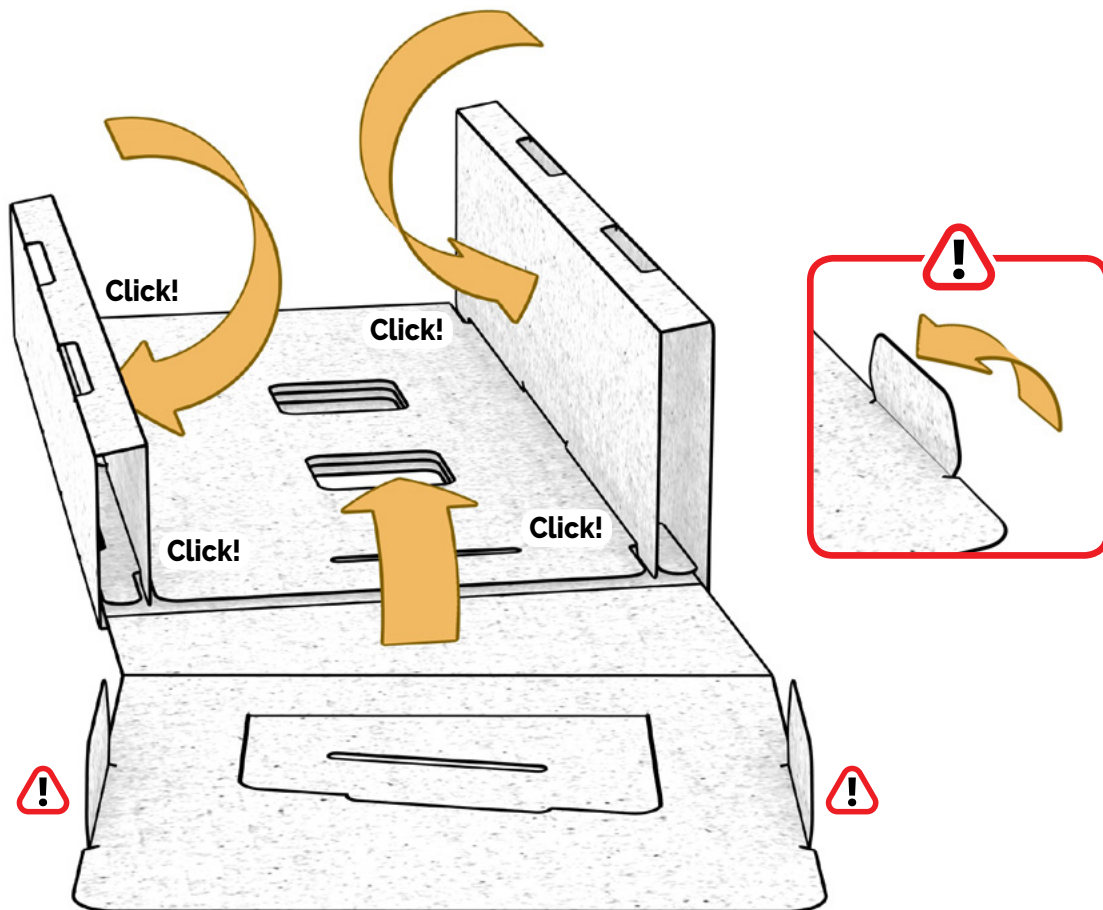

7

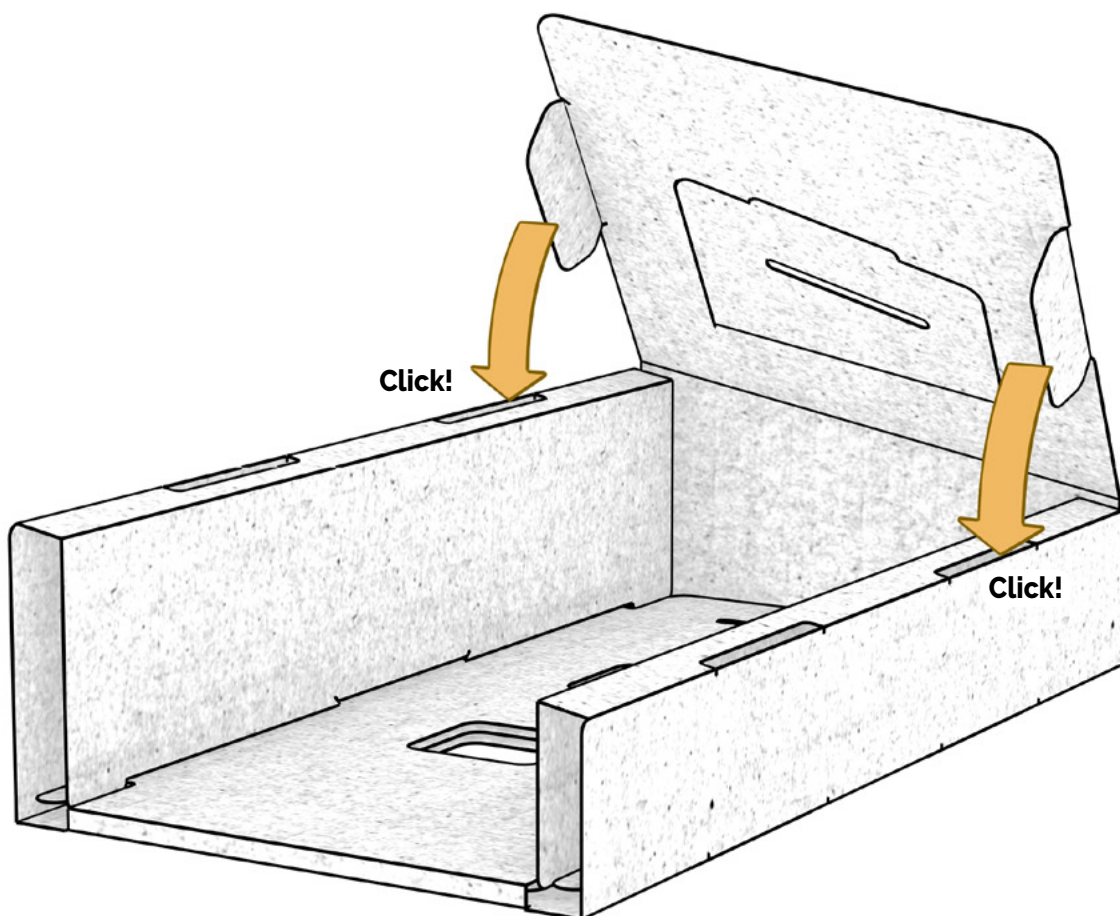

8

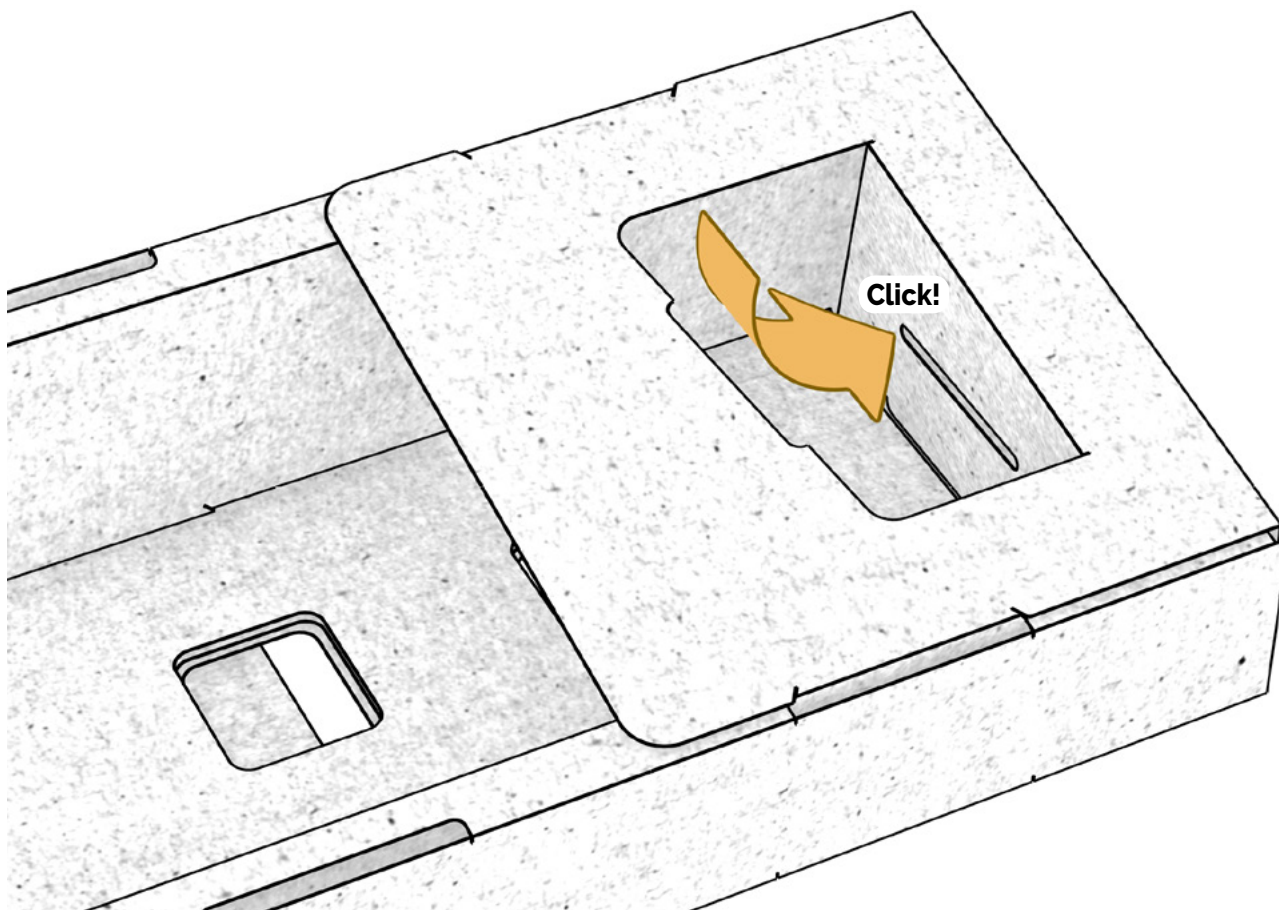

9

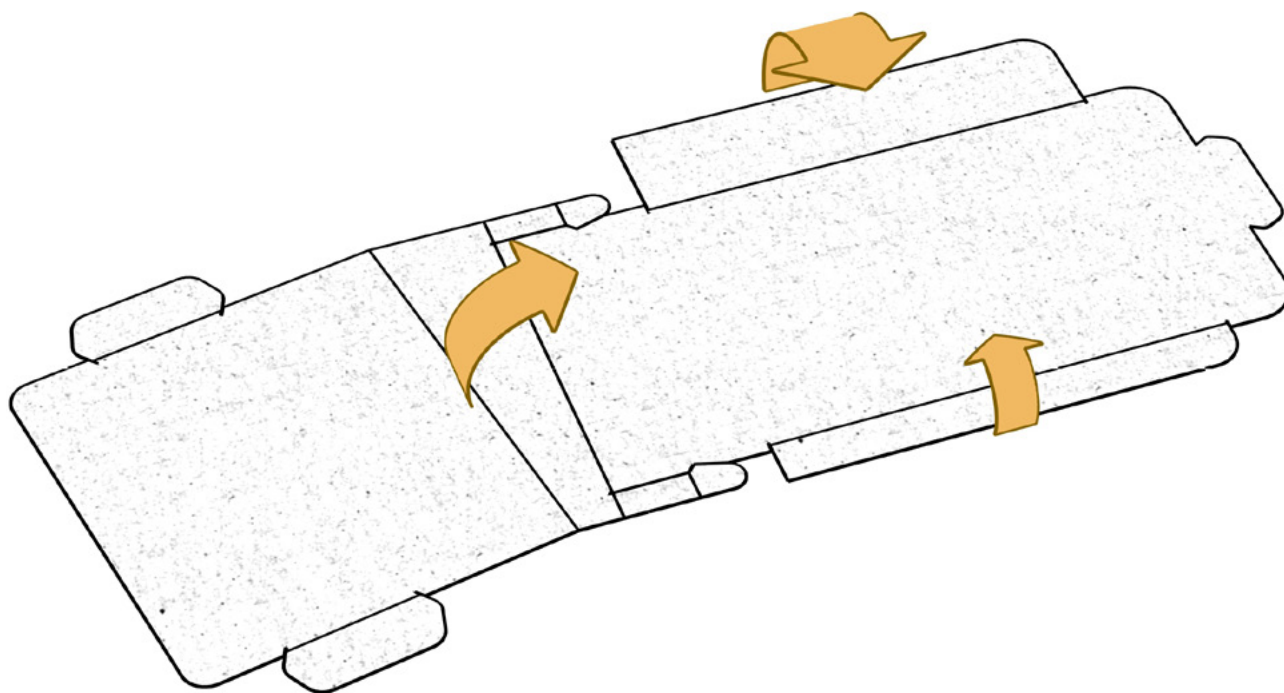

10

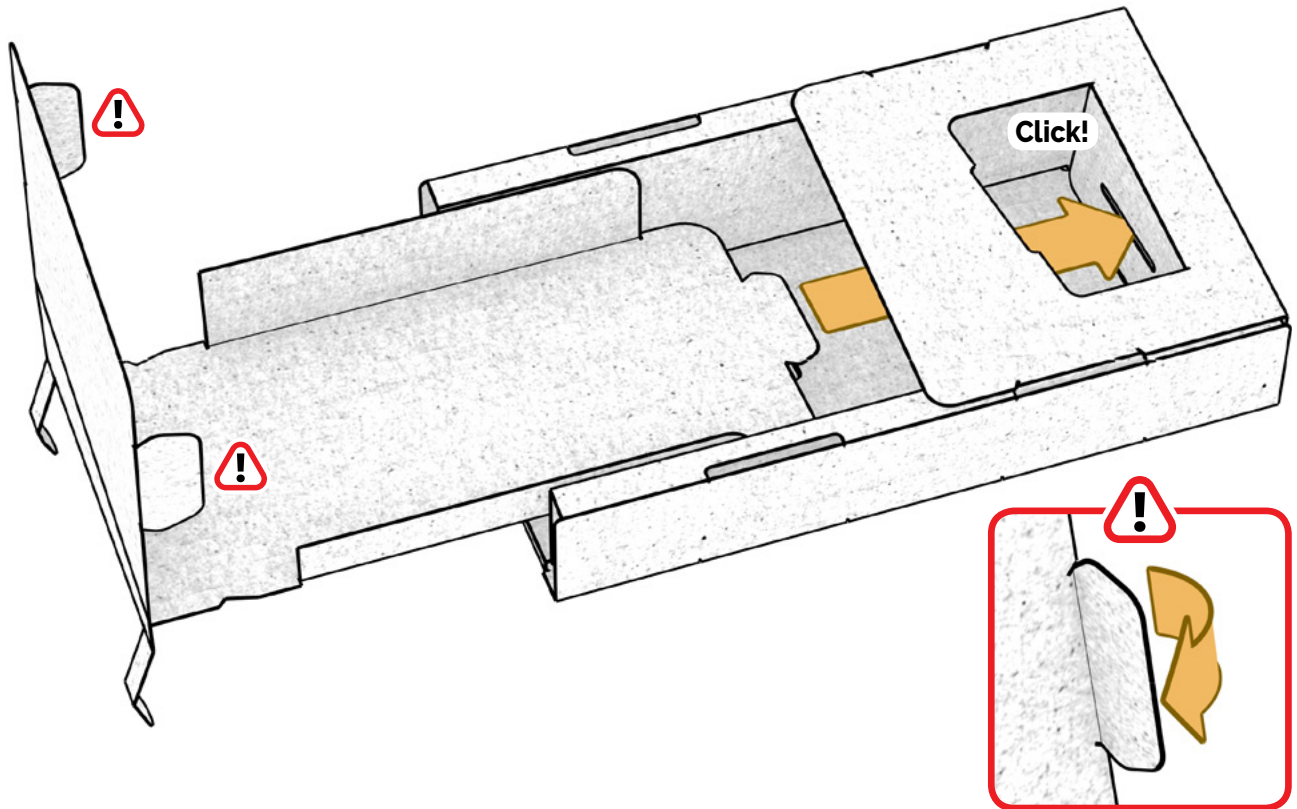

11

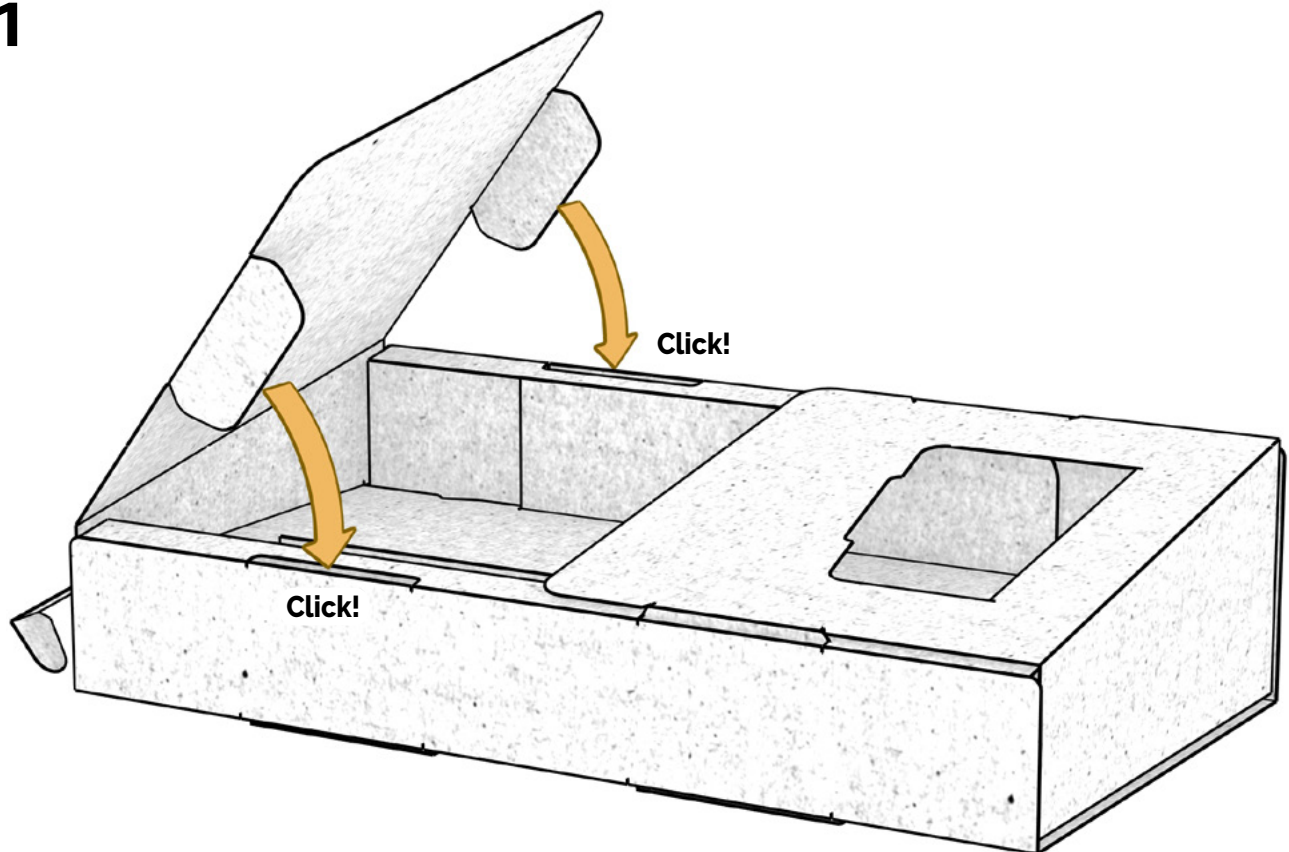

12

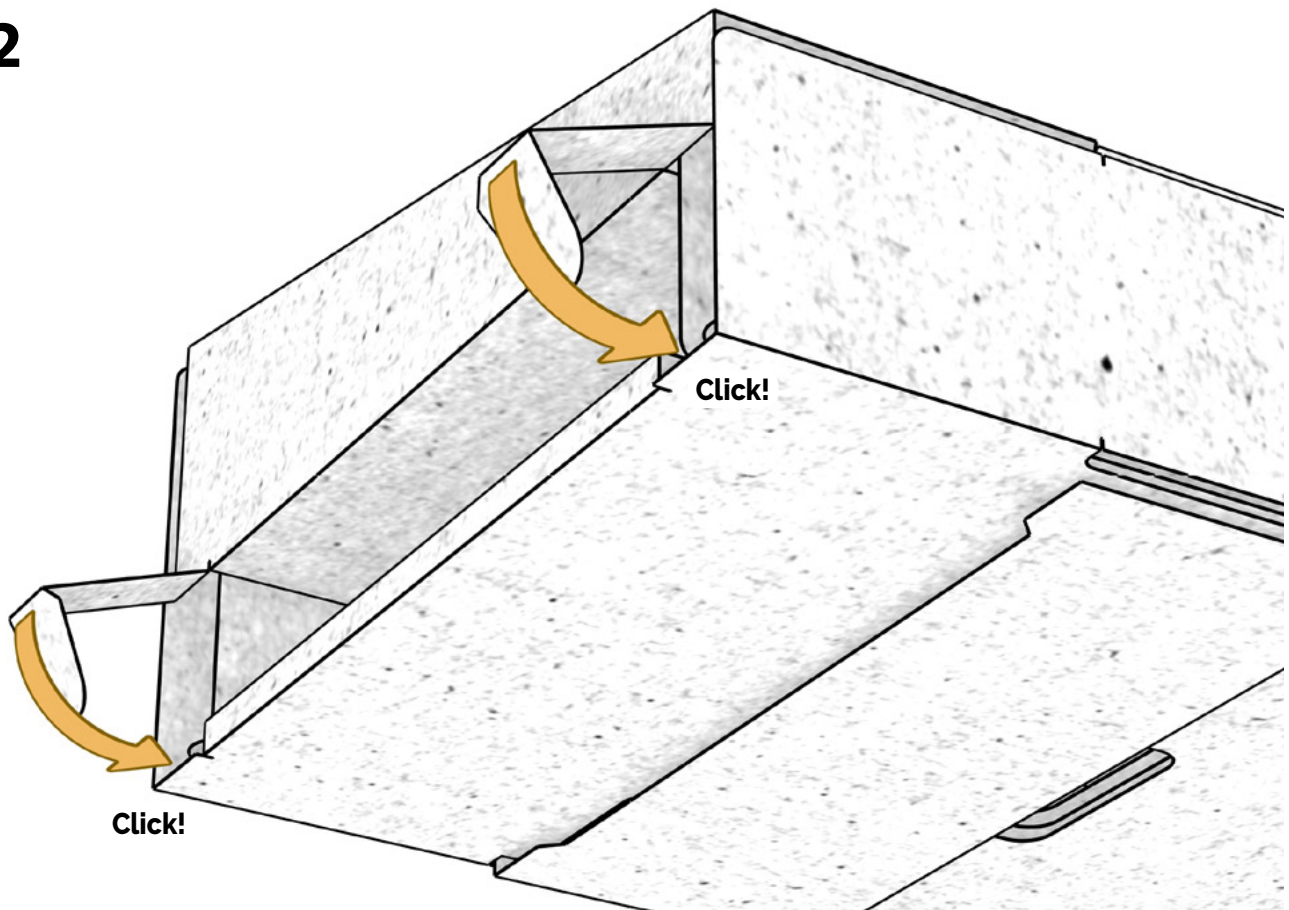

13

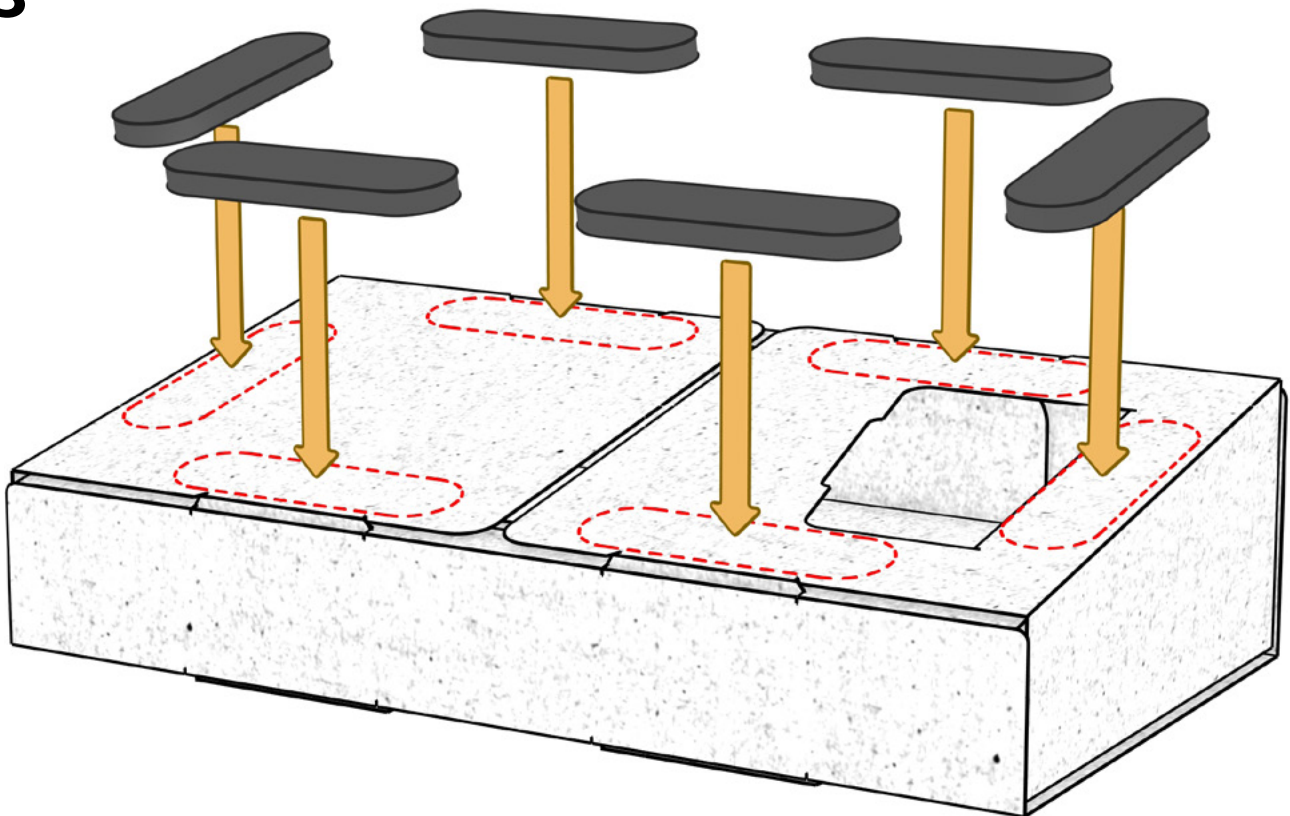

14

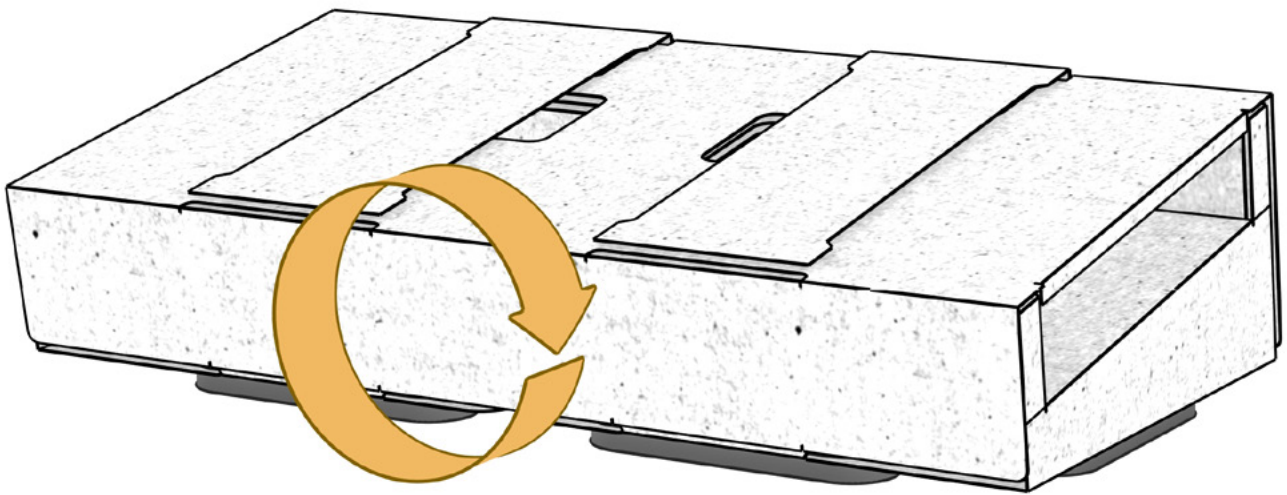

15

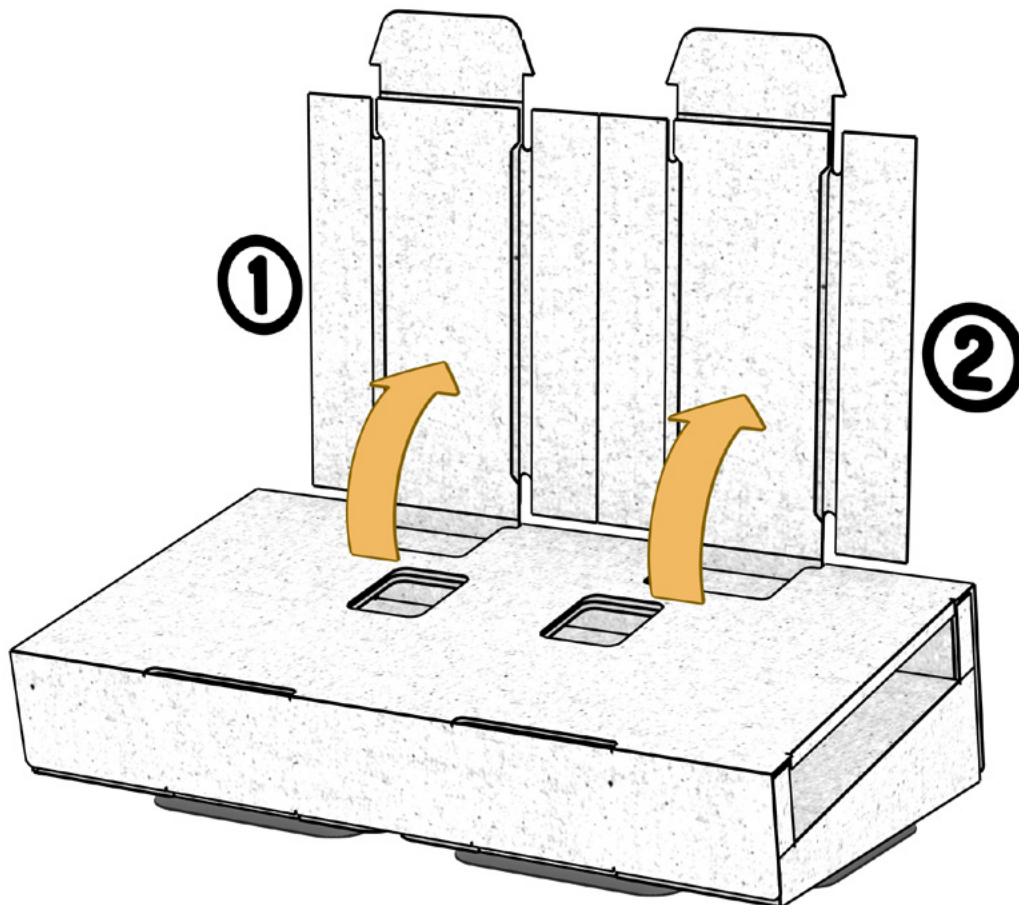

16

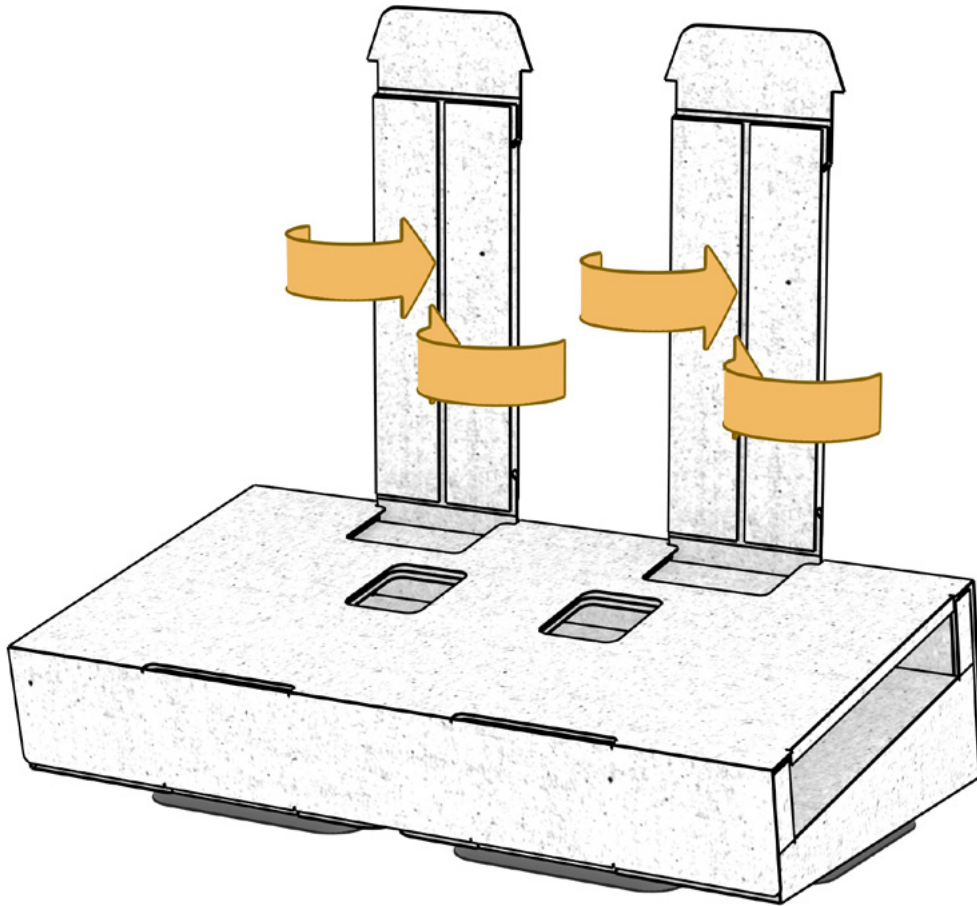

17

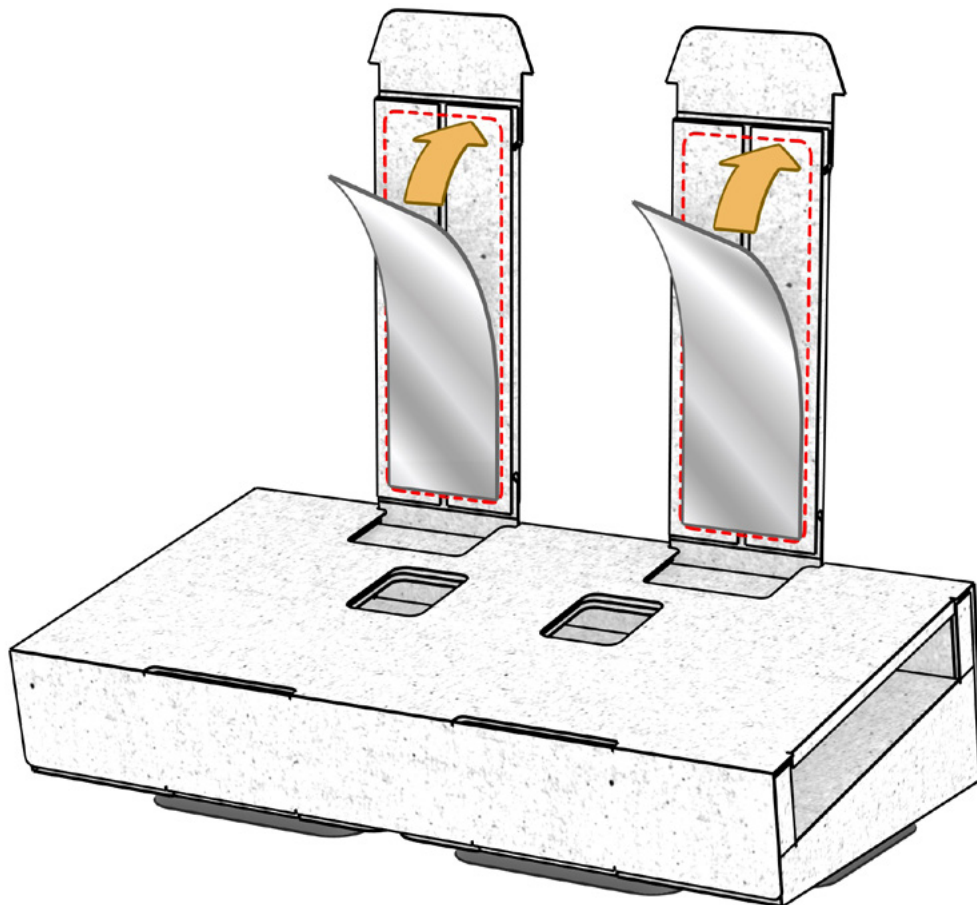

18

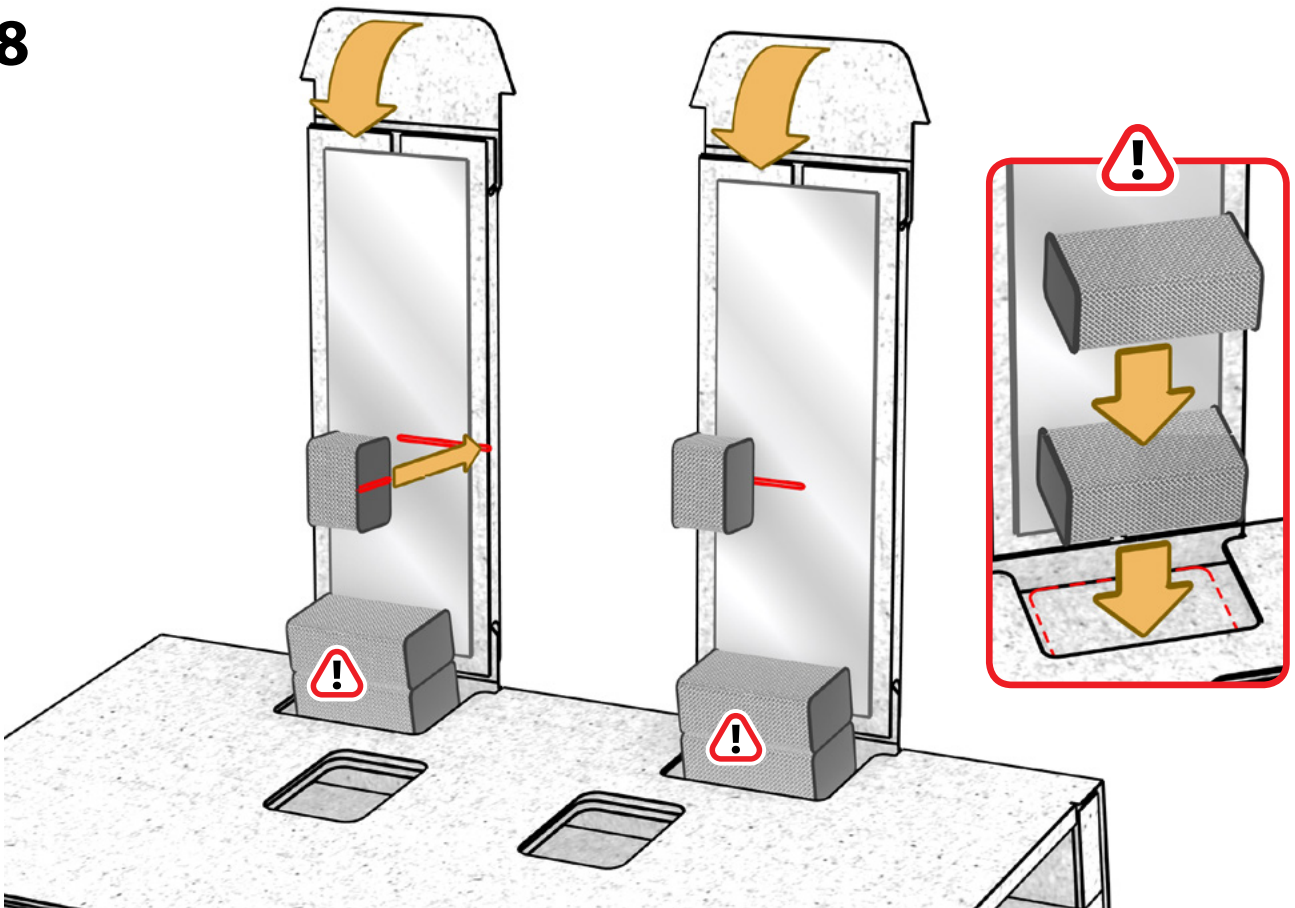

19

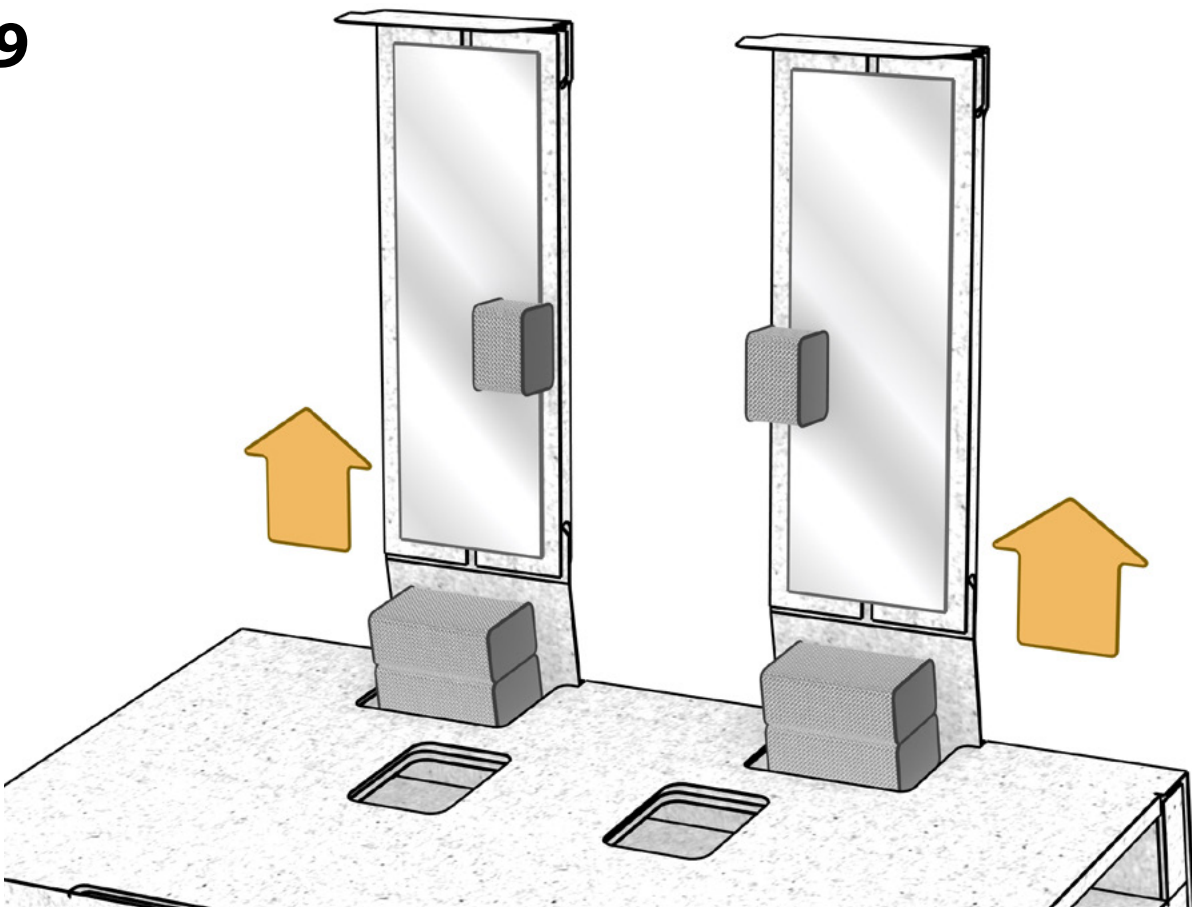

20

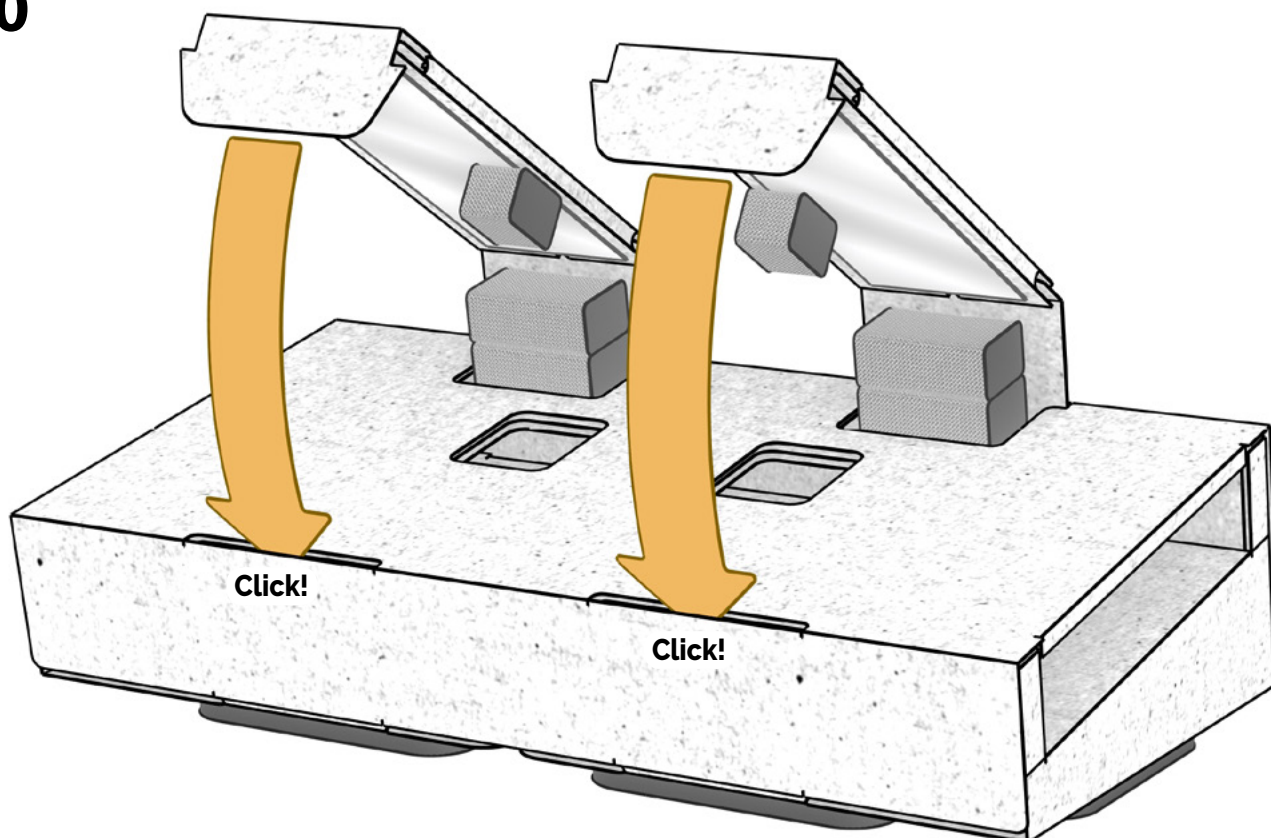

21

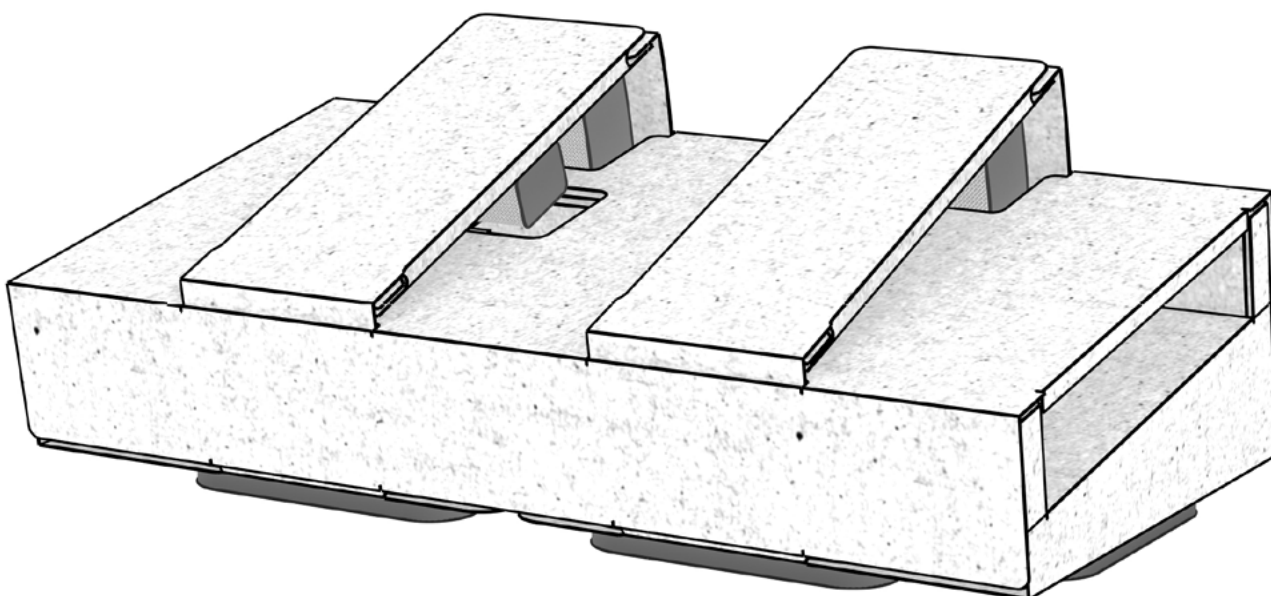

22

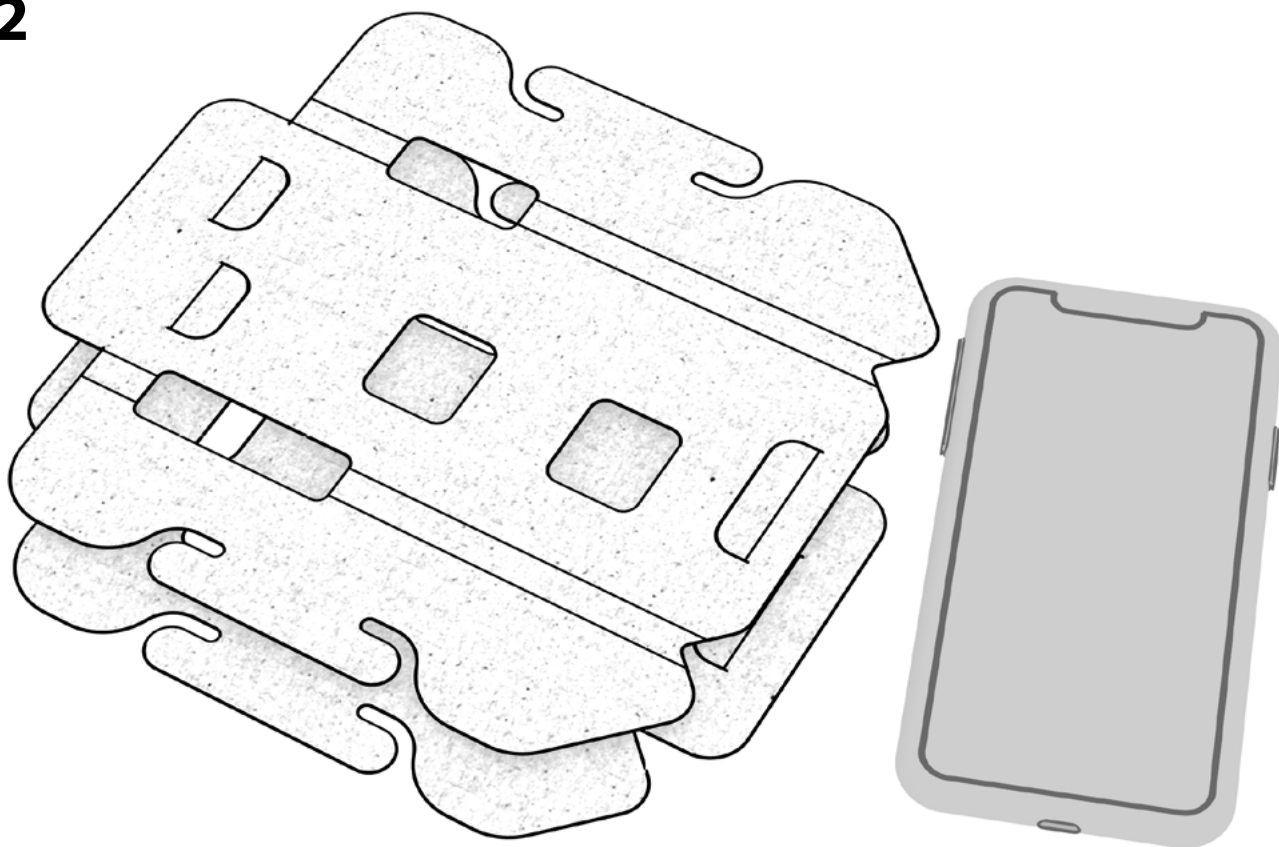

23

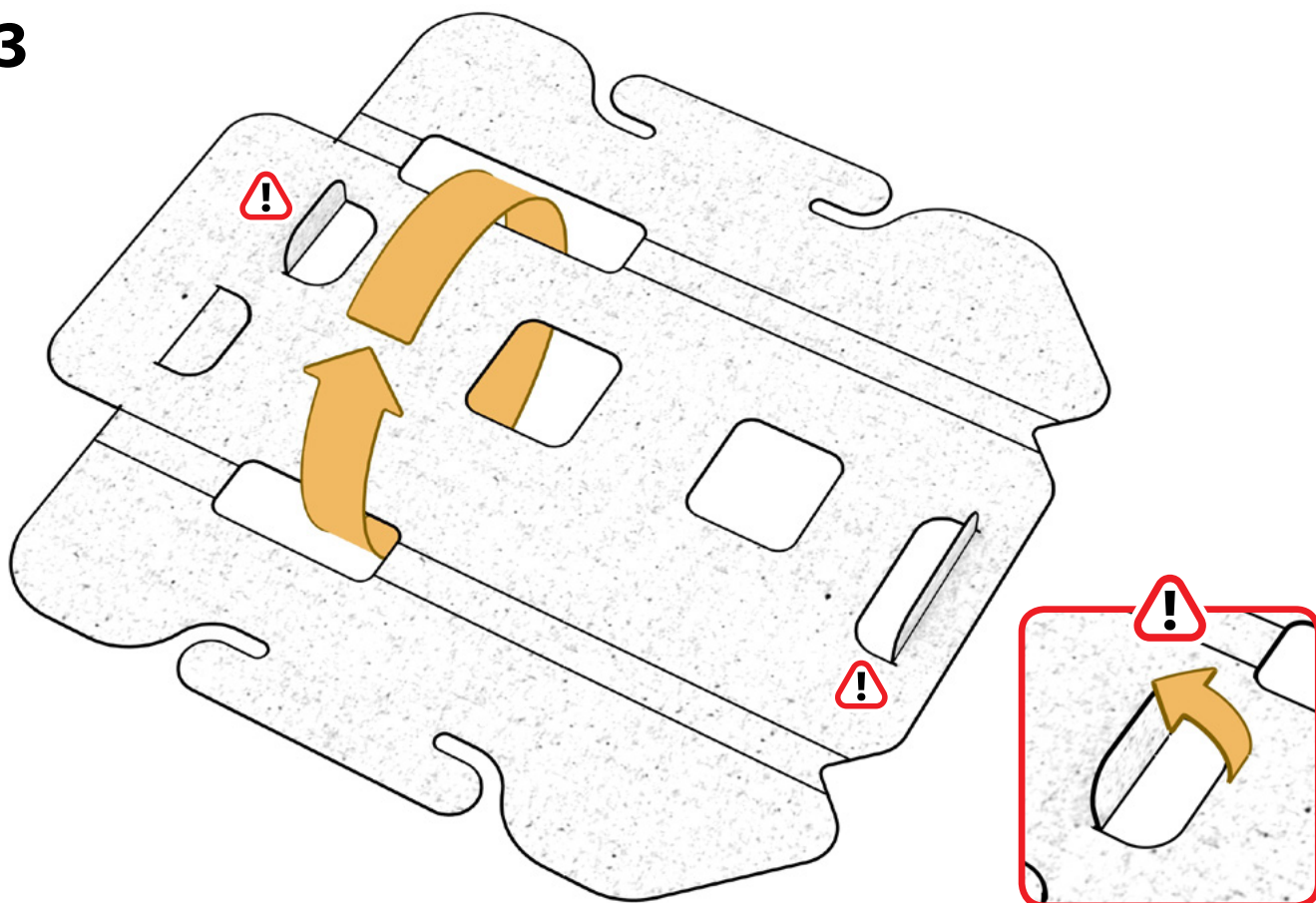

24

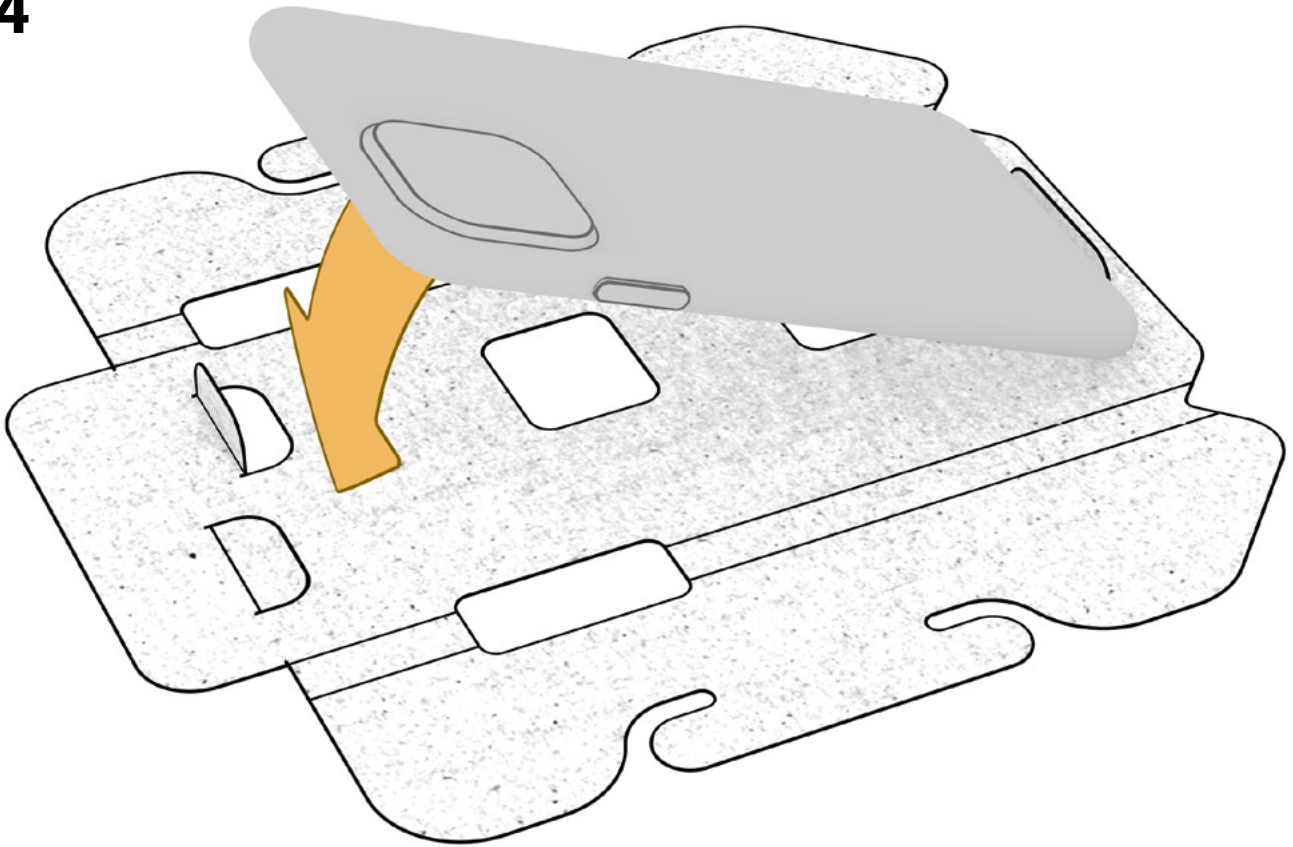

25

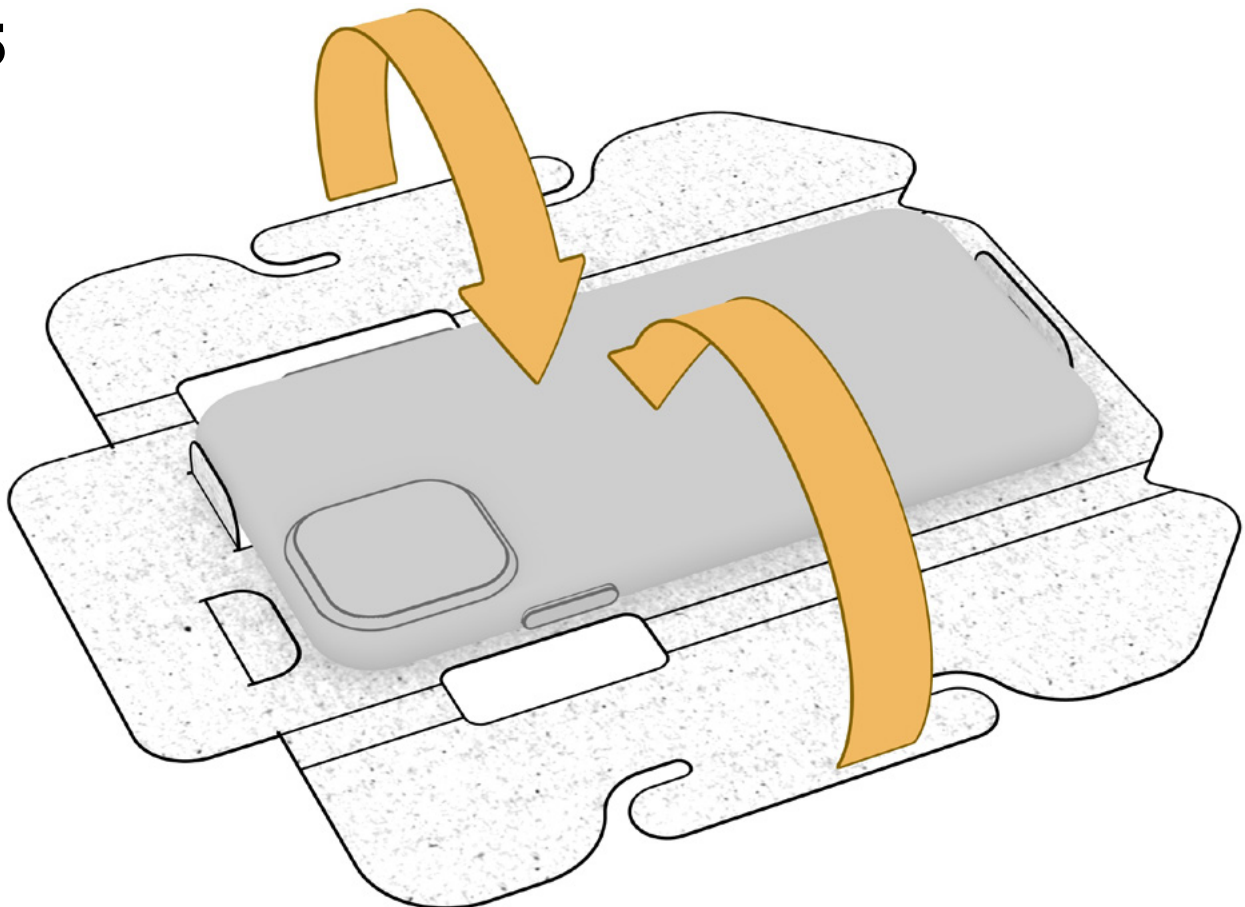

26

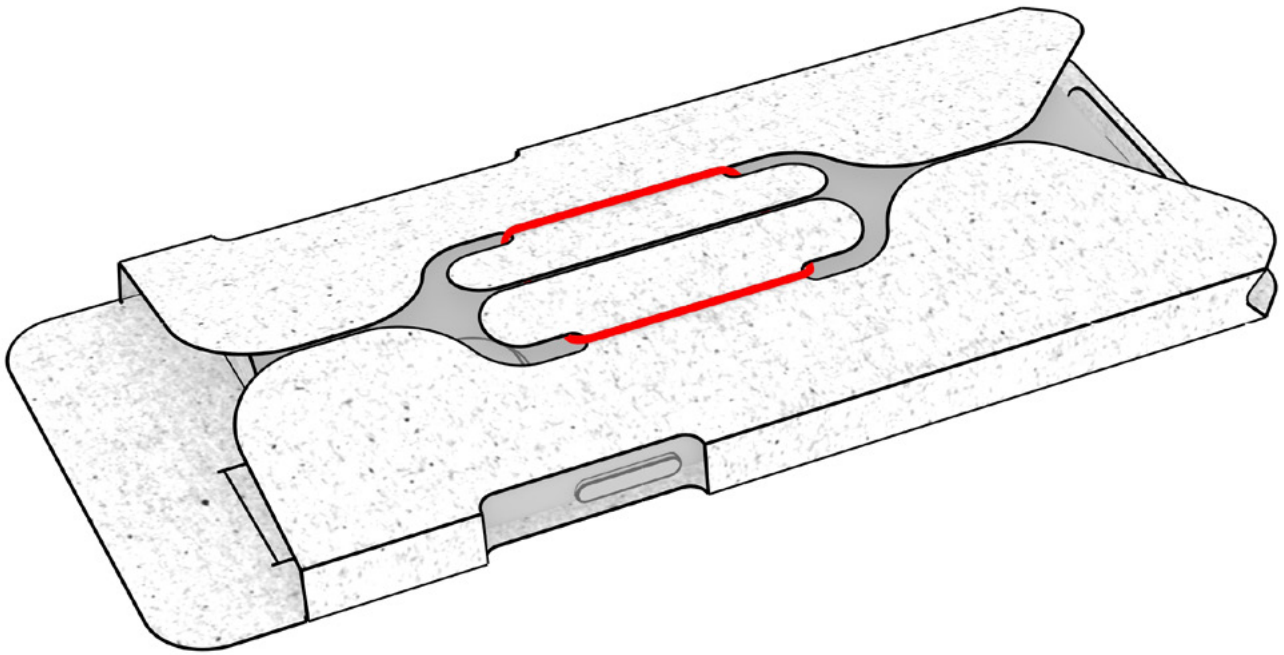

27

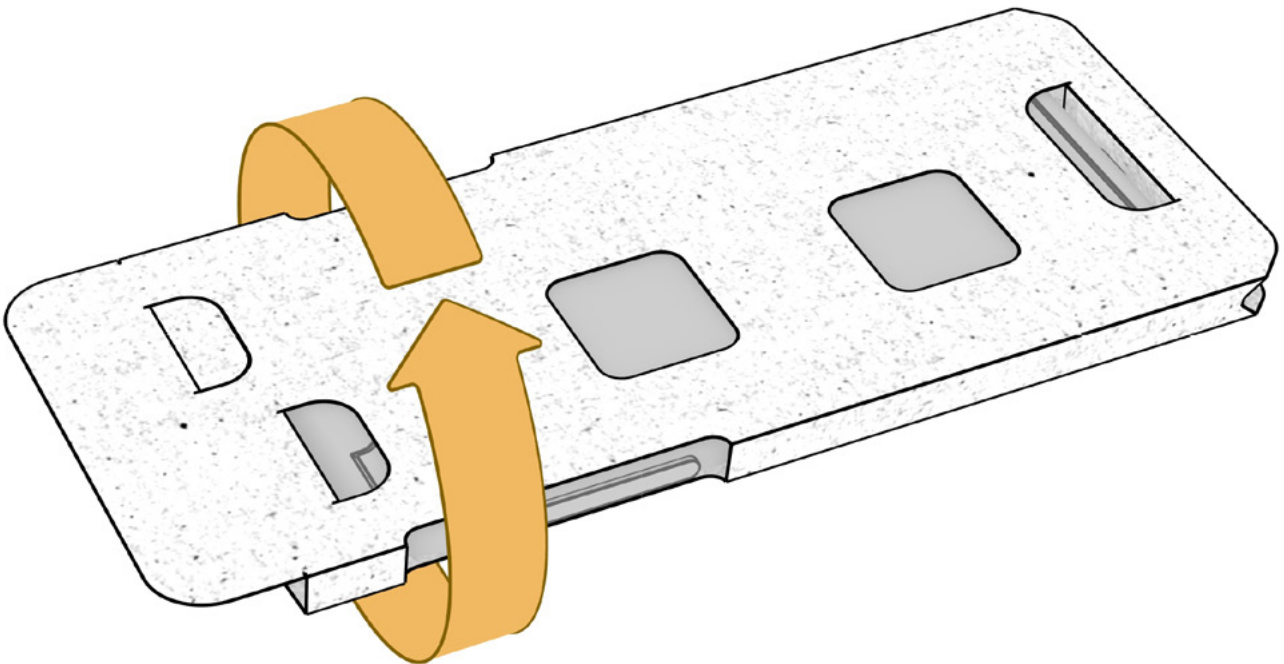

Your pedal is almost ready.

Now you just have to add an iPhone so that the cardboard pedal turns into a full-fledged MIDI foot controller.

1. Start the MIDI Footswitch app.
2. Connect it with MacOS* via Wi-Fi or Bluetooth according to the guide in the application.
3. Place the iPhone in the tray with the screen on, and insert the tray into the pocket in the pedal with the screen facing up.

* For Windows PCs we recommend using a compatible solution: [rtpMIDI](#).

Have fun!

